

九二东路延伸段界址图

2737.28-40364.68

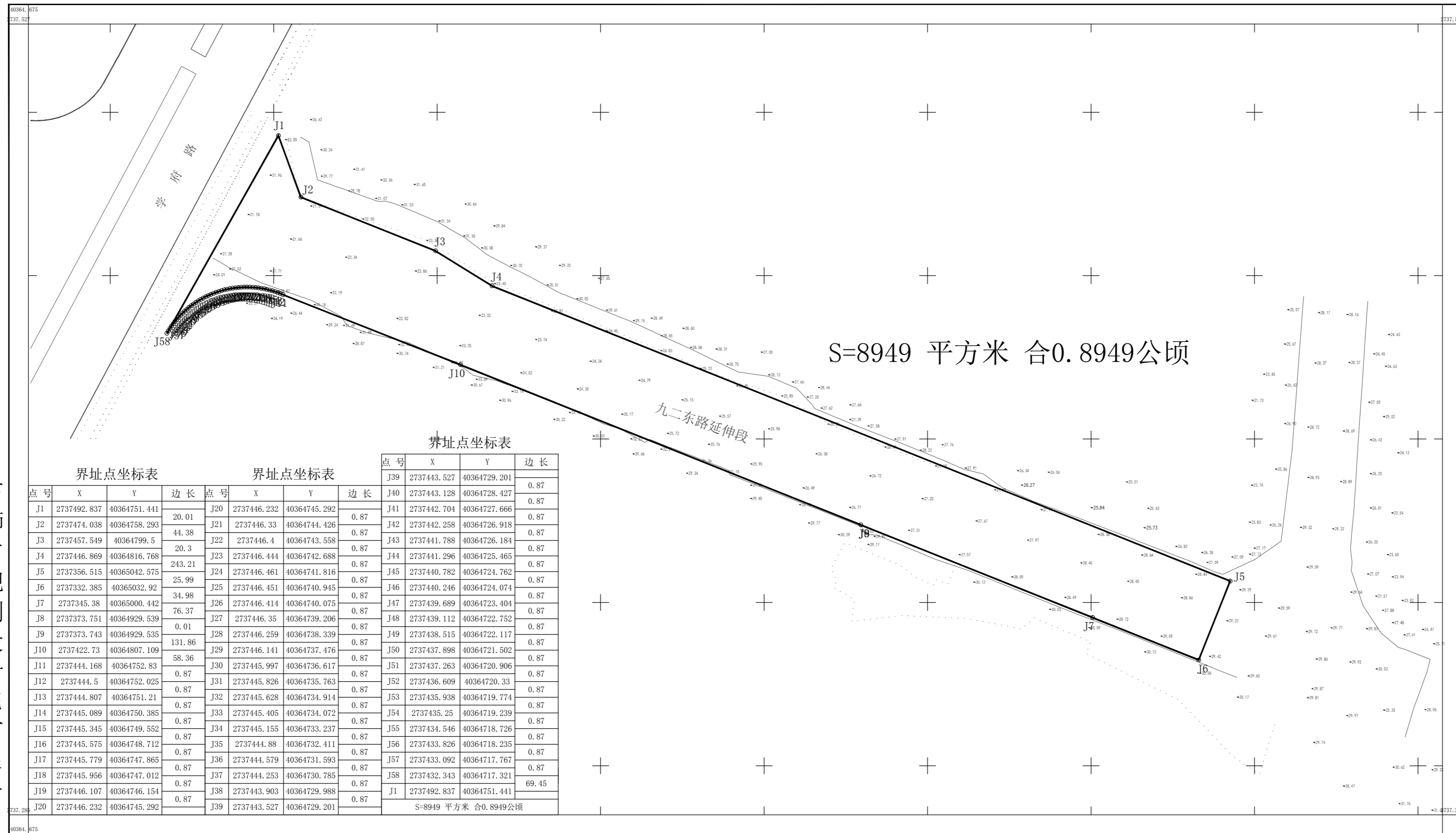

S=8949 平方米 合0.8949公顷

界址点坐标表

界址点坐标表			界址点坐标表			界址点坐标表					
点号	X	Y	边长	点号	X	Y	边长	点号	X	Y	边长
J1	2737492.837	40364751.441	20.01	J20	2737446.232	40364745.292	0.87	J39	2737443.527	40364729.201	0.87
J2	2737474.038	40364758.293	44.38	J21	2737446.33	40364744.426	0.87	J40	2737443.128	40364728.427	0.87
J3	2737457.549	40364799.5	20.3	J22	2737446.4	40364743.558	0.87	J41	2737442.704	40364727.666	0.87
J4	2737446.869	40364816.768	243.21	J23	2737446.444	40364742.688	0.87	J42	2737442.258	40364726.918	0.87
J5	2737356.515	40365042.575	25.99	J24	2737446.461	40364741.816	0.87	J43	2737441.788	40364726.184	0.87
J6	2737332.385	40365032.92	34.98	J25	2737446.451	40364740.945	0.87	J44	2737441.296	40364725.465	0.87
J7	2737345.38	40365000.442	76.37	J26	2737446.414	40364740.075	0.87	J45	2737440.782	40364724.762	0.87
J8	2737373.751	40364929.539	0.01	J27	2737446.35	40364739.206	0.87	J46	2737440.246	40364724.074	0.87
J9	2737373.743	40364929.535	131.86	J28	2737446.259	40364738.339	0.87	J47	2737439.689	40364723.404	0.87
J10	2737422.73	40364807.109	58.36	J29	2737446.141	40364737.476	0.87	J48	2737439.112	40364722.752	0.87
J11	2737444.168	40364752.83	0.87	J30	2737445.997	40364736.617	0.87	J49	2737438.515	40364722.117	0.87
J12	2737444.5	40364752.025	0.87	J31	2737445.826	40364735.763	0.87	J50	2737437.898	40364721.502	0.87
J13	2737444.807	40364751.21	0.87	J32	2737445.628	40364734.914	0.87	J51	2737437.263	40364720.906	0.87
J14	2737445.089	40364750.385	0.87	J33	2737445.405	40364734.072	0.87	J52	2737436.609	40364720.33	0.87
J15	2737445.345	40364749.552	0.87	J34	2737445.155	40364733.237	0.87	J53	2737435.938	40364719.774	0.87
J16	2737445.575	40364748.712	0.87	J35	2737444.88	40364732.411	0.87	J54	2737435.25	40364719.239	0.87
J17	2737445.779	40364747.865	0.87	J36	2737444.579	40364731.593	0.87	J55	2737434.546	40364718.726	0.87
J18	2737445.956	40364747.012	0.87	J37	2737444.253	40364730.785	0.87	J56	2737433.826	40364718.235	0.87
J19	2737446.107	40364746.154	0.87	J38	2737443.903	40364729.988	0.87	J57	2737433.092	40364717.767	0.87
J20	2737446.232	40364745.292	0.87	J39	2737443.527	40364729.201	0.87	J58	2737432.343	40364717.321	0.87
S=8949 平方米 合0.8949公顷											

石狮市规划设计院有限公司

2025年10月数字化制图。
CGCS2000坐标系，中央子午线120度。
1985国家高程基准，等高距为1米。

1:1600

测量员：陈伟强
绘图员：庄学杰
检查员：郭先通